

US ROUTE 20

S89°04'46"E
1954.05'
NORTHWEST CORNER
NORTHWEST QUARTER
SECTION 26

*PLAT OF SURVEY
FOR
T. HENDRICKS*

*SITUATED IN:
THE NW. 1/4,
SECTION 26
TOWN 9 S. RANGE 2 W.,
MADISON TOWNSHIP,
WILLIAMS COUNTY, OHIO*

KUNKLE FAMILY FARMS PPL
O.R. 184, PG. 417
36.87 AC.

S89°04'46"E
602.82' NORTH LINE NORTHWEST QUARTER 190.19'

N89°04'46"W 2653.81'

2605.34' NORTH LINE NORTHEAST QUARTER

NORTHEAST CORNER
NORTHEAST QUARTER
SECTION 22

NORTHEAST CORNER
NORTHWEST QUARTER
SECTION 22

90' BUILDING SETBACK LINE

7.160 ACRES

NORTH AND BEARING
SYSTEM BASED ON
OHIO NORTH STATE
PLANE GRID, NAD 83
ADJ. 2011.

N01°19'12"E
517.08'

517.49'
S01°17'30"W

$$\sqrt{W} = \frac{1}{4}$$

603.08'
N89°02'28"W

LEGEND:

- ☐ 5/8" IRON PIN FOUND
- ☒ PK NAIL FOUND
- ☐ MAG NAIL SET
- ☒ 5/8" IRON PIN W/ CAP SET

TODD E. AND AMY S. HENDRICKS
O.R. 184, PG. 1880
43,549 AC.

THIS PLAT IS BASED ON AN ACTUAL FIELD SURVEY.

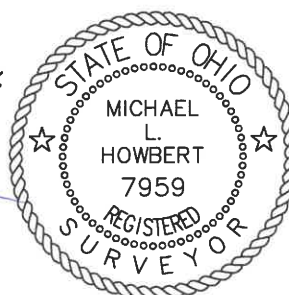

MICHAEL L. HOWBERT
REGISTERED PROFESSIONAL
SURVEYOR NO. 7959 IN OHIO
MARCH 15, 2025

NOTES:

FOUND MONUMENTATION IN GOOD CONDITION
UNLESS OTHERWISE NOTED.
DATA SOURCES INCLUDE DOCUMENTS CITED.

A TITLE SEARCH IS RECOMMENDED TO DETERMINE EASEMENTS, RESTRICTIONS, AND/OR OTHER ENCUMBRANCES AFFECTING THE PROPERTY SHOWN HEREON.

